



SOMMER

MASCHINENBAU

QuickMessKit

The individual measuring system for retrofitting

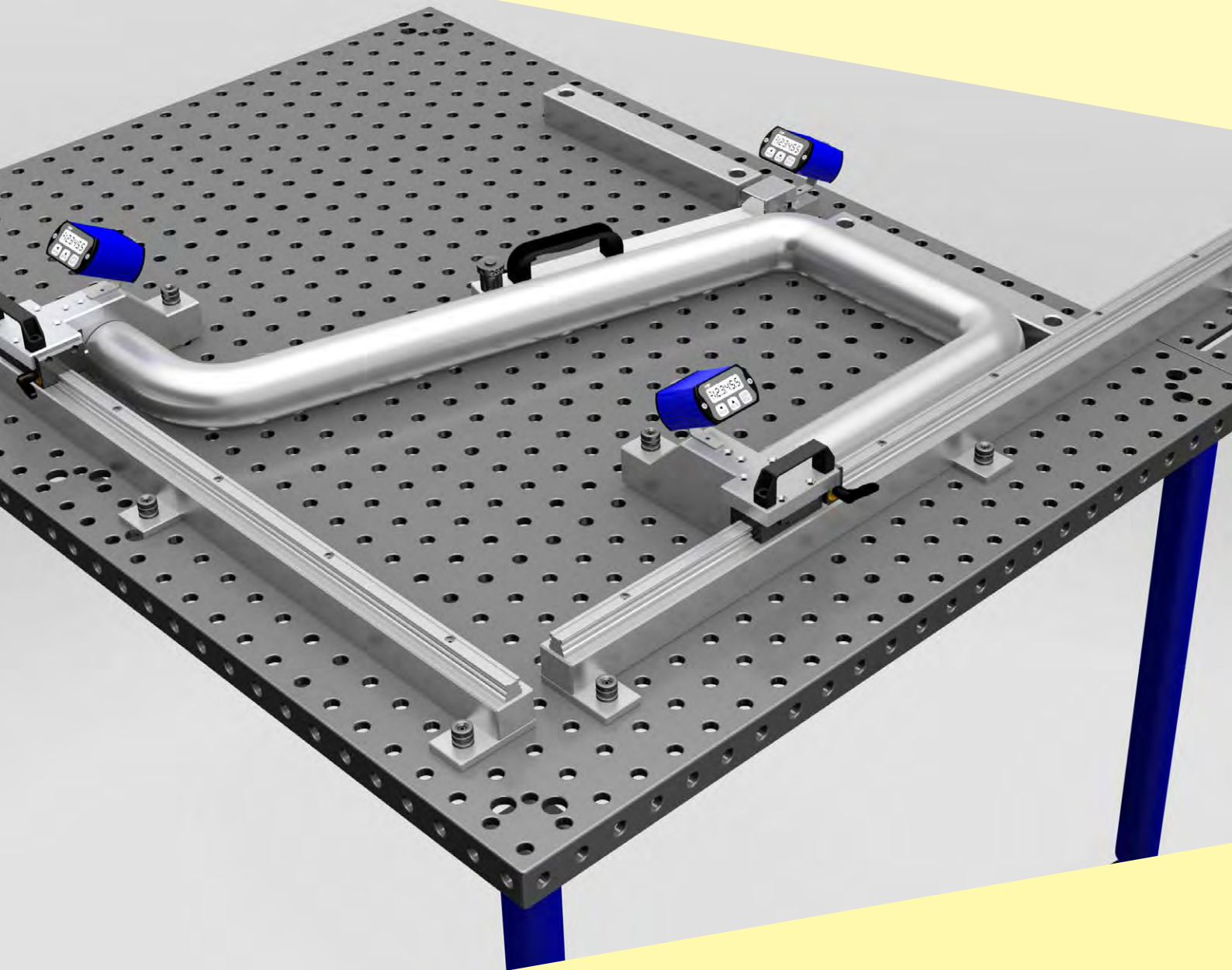

...simple measurement

Control

QuickMessKit

System: magnetic
 Resolution: length 0,1 mm
 angle 1° or 0,1°
 Display: battery-operated (4 years)
 Usage: measurement of tubes,
 angles, profiles etc.
 Compatible with 16mm hole system
 (28mm on demand)

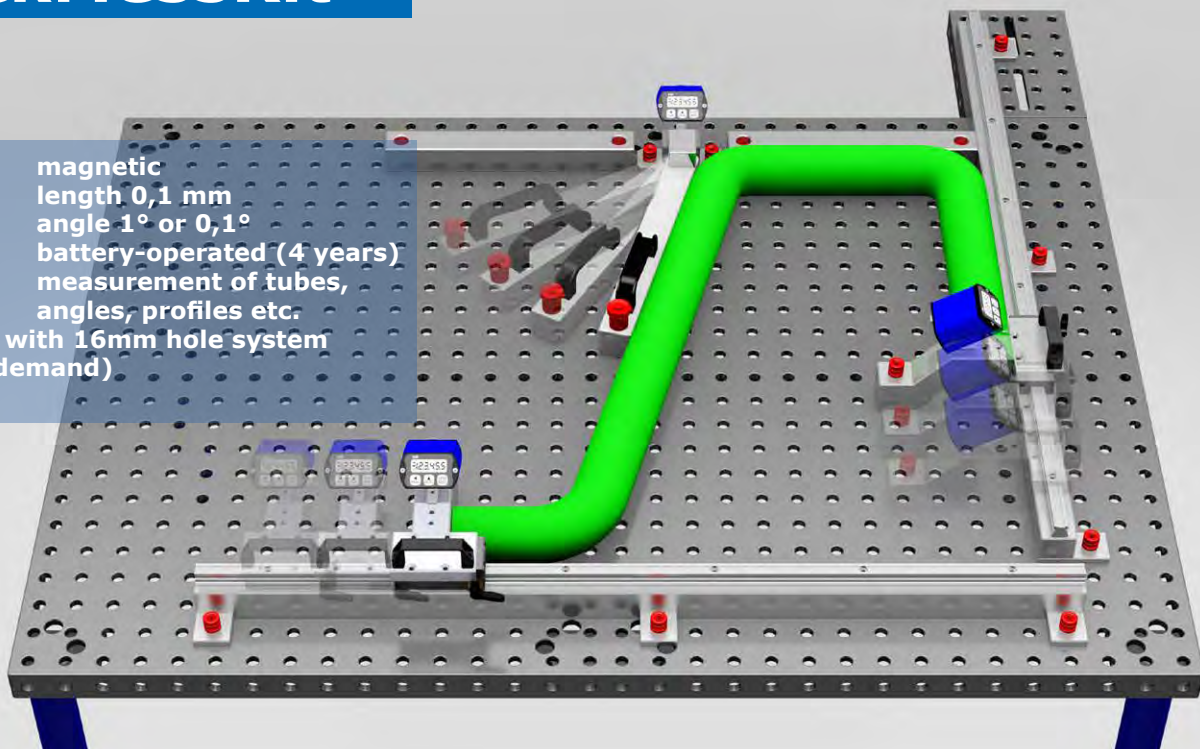

Flexible, personalized and **fast** are characteristics of the **QuickMessKit** system. Through a simple plug-in system every user can compile easily and quickly his own measuring system. The aim is a quick and accurate measuring to increase the quality.

The **QuickMessKit** is composed of the components **Fix**, **Linear** and **Angle**. These three stop systems can be ordered individually and assembled as needed. Whether for retrofitting your existing welding table (system 16mm / system 28mm on request) or as a complete solution (measuring system + welding table) we offer in various sizes a professional measurement solution.

QuickMessKit - Fix

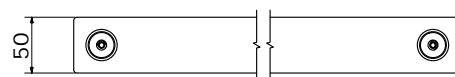
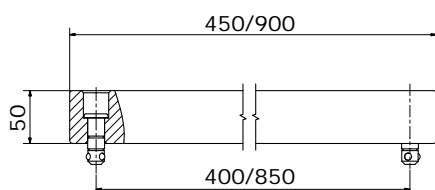
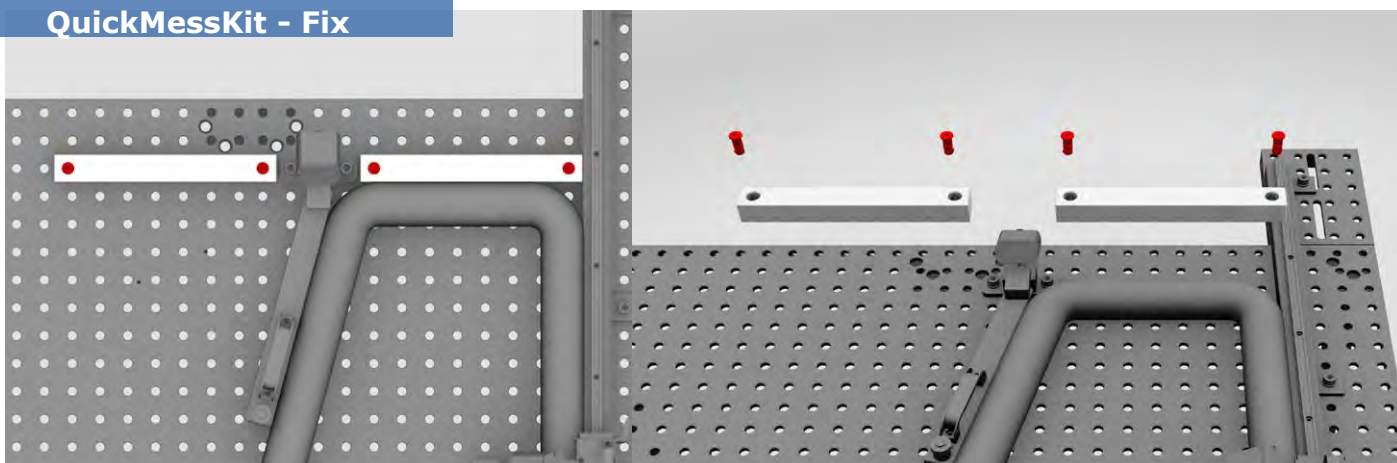

Ordering key:
 SMB-F-450
 SMB-F-900

QuickMessKit - Linear

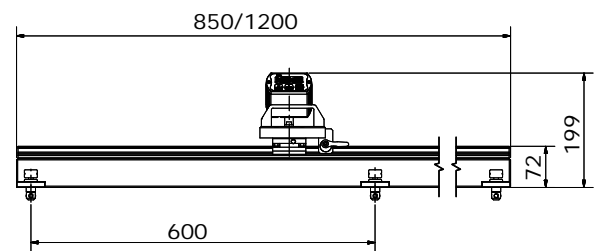
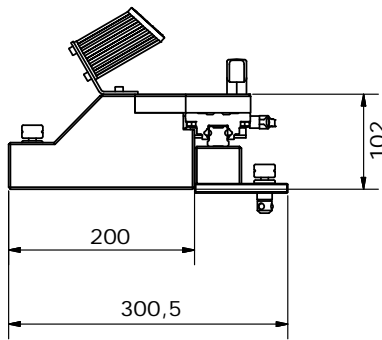
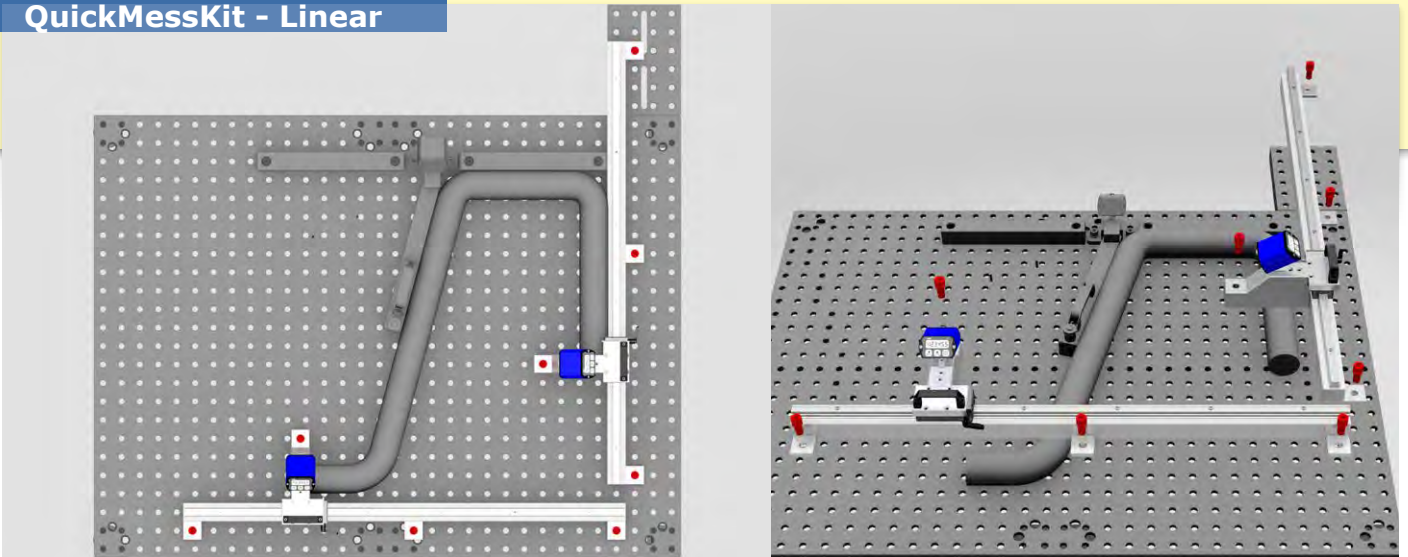

Ordering key:
SMB-L-850
SMB-L-1200

QuickMessKit - Angle

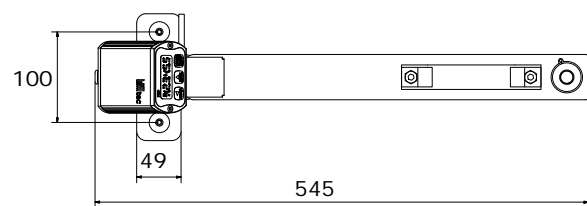
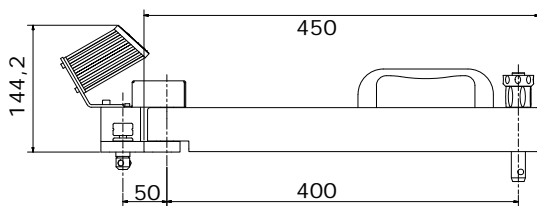
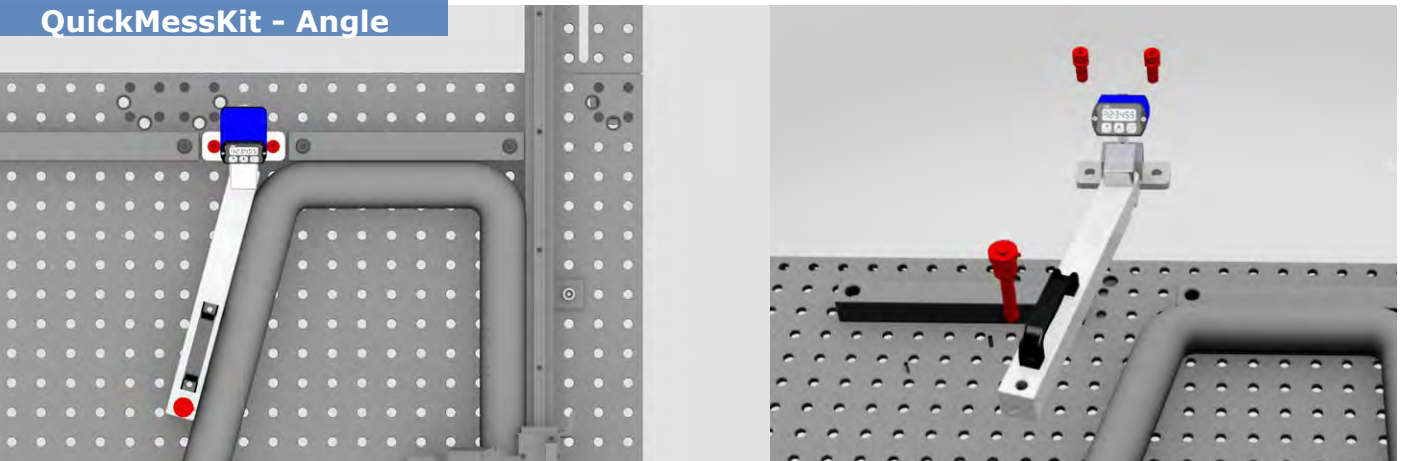

Ordering key:
SMB-W-450

SOMMER MASCHINENBAU GMBH

SOMMER Maschinenbau GmbH creates and distributes customer solutions. We advise and support them from the initial inquiry to the realization. In addition, we guarantee a prompt and professional service for all our products - worldwide.

We look forward to your inquiry...

MANDREL BENDING MACHINES

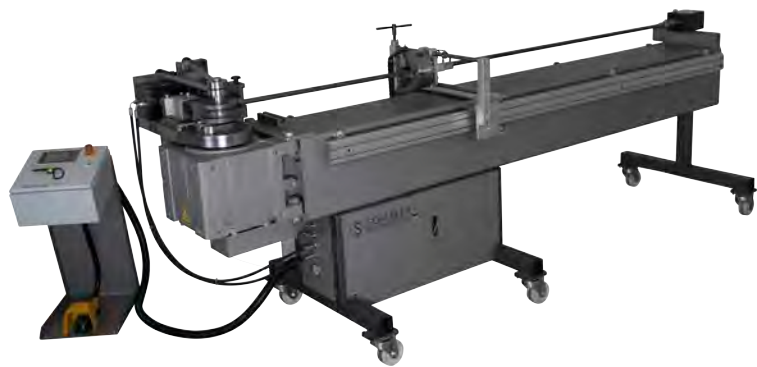

MANUAL BENDING DEVICES



TUBE DRILLING MACHINES



HORIZONTAL PRESSES



Sommer Maschinenbau GmbH
Hinter dem Entenpfuhl 6
65604 Elz / GERMANY

Tel. +49 6431 7797923

info@maschinenbau-sommer.de
www.maschinenbau-sommer.de